



NT Shank

DINOX NC TOTAL TOOLING SYSTEM

NT-NPM	174
NT-NPM SET	175
NT-FMA	176

NT-NPM

New power milling chuck

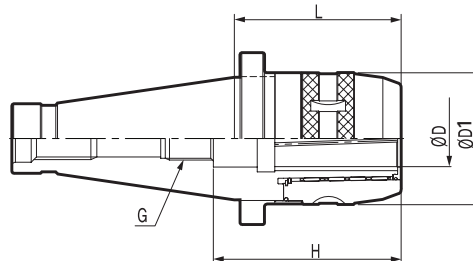

- For more information on the product features, see **Page 24**.
- For more information on the applicable collet, see **Page 74**.
- For more information on the related parts, see **Page 77**.
- For more information on BT shank, see **Page 72**.
- For more information, see **Page 148** for HSK shank and **Page 160** for SK shank.

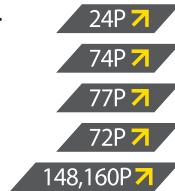

C This product does not support the internal coolant system.

Designation	ØD	L	ØD1	G	COLLET	Kg	Total Weight (Kg)
NT40-NPM32-95	32	95	75	U5/8"-11	DC32,DCS32	2.7	2.9
NT50-NPM32-95	32	95	75	U1"-8	DC32,DCS32	4.3	4.6
NT50M-NPM32-95	32	95	75	M24	DC32,DCS32	4.4	4.7
NT50-NPM42-95	42	95	90	U1"-8	DC42,DCS42	4.8	5.1
NT50M-NPM42-95	42	95	90	M24	DC42,DCS42	4.9	5.2

NT-NPM SET

New power milling chuck set.

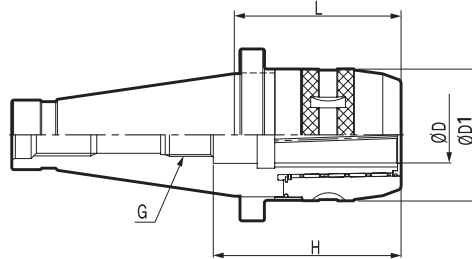





C This product does not support internal coolant system.

• For more information on the features of product, see **Page 24**.

24P ↗

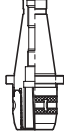
• For more information on BT shank, see **Page 73**.

73P ↗

Designation	Body	Collet	MT collet	DJT	Spanner	Kg	Total Weight (Kg)
							
NT40-NPM32-95(B)	NT40-NPM32-95	DC32-6, 8, 10, 12, 16, 20, 25	TC32-MT1,2,3	DJT32-6	75-79	6.4	7.1
NT50-NPM32-95(B)	NT50-NPM32-95	DC32-6, 8, 10, 12, 16, 20, 25	TC32-MT1,2,3	DJT32-6	75-79	7.7	10.0
NT50-NPM42-95(B)	NT50-NPM42-95	DC42-6,8,10,12,16,20,25,32	TC42-MT1,2,3,4	DJT42-6	92-96	12.7	15.2

Feature

BT shank

S,ST shank

HSK shank

SK shank

NT Shank

cBN/PCD

Other

